



Paroc Panel System:	Fire	Detail No.:	FI-E-301
Date:	Feb2004	Type:	Cladding detail
Signature:	KjN	Subject:	Fixing to steel column Horizontal installation
Scale:	1:5		

Note: Principle Master Detail

Any changes are at the designer's responsibility

Copyright by Paroc Oy AB, Panel System

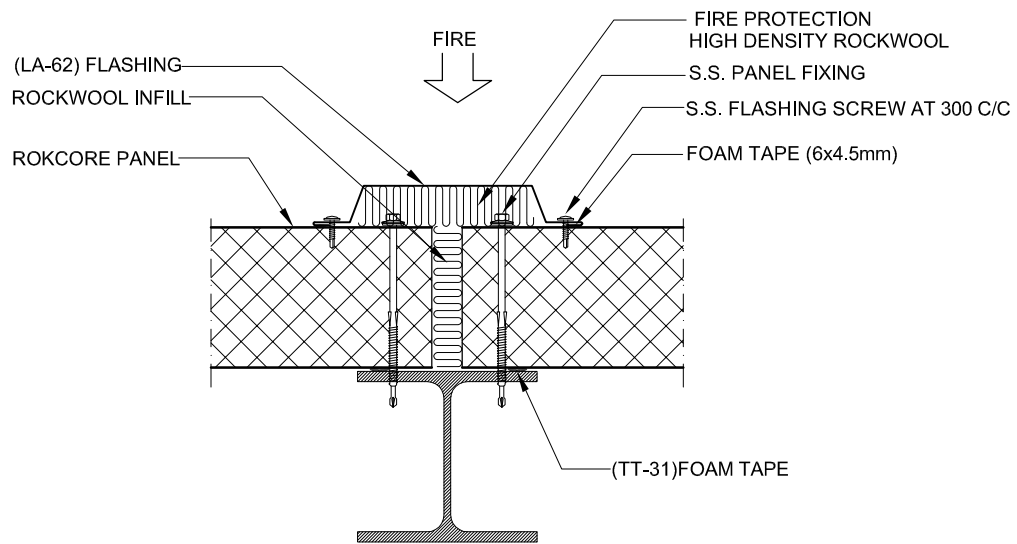

NOTE: In fire partition walls/ceilings
use stainless steel screws/rivets